



MASTER Room 1, 14 Union Terrace, Leeds, West Yorkshire, LS7 3DN

AVAILABLE 2nd June 2026

A large double bedroom to rent in a spacious five bedroom, two bathroom shared house in Chapel Allerton. The first floor bedroom is fully furnished and includes a corner sink unit.

The house benefits from a large living room with a separate kitchen and dining room. There is a private yard for extra storage and a secure bike store.

Union Terrace is located within the residential heart of Chapel Allerton, with the main high street less than 0.5m away.

On street parking is available and regular bus routes into town depart from nearby Harrogate Road.

- Room in a Shared House
- Chapel Allerton
- Fully Furnished
- Huge Rooms
- Basement Storage
- Sink in Bedroom

£595 Per month

www.fletcherprops.com

BASEMENT
225 sq.ft. (20.5 sq.m.) approx.



GROUND FLOOR
389 sq.ft. (35.5 sq.m.) approx.

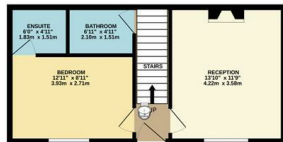

1ST FLOOR
393 sq.ft. (36.5 sq.m.) approx.

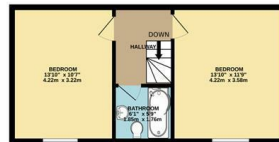

2ND FLOOR
393 sq.ft. (36.5 sq.m.) approx.

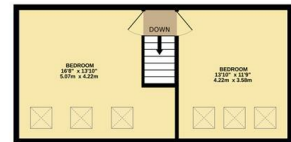

TOTAL FLOOR AREA: 1395 sq.ft. (129.6 sq.m.) approx.

Whilst every attempt has been made to ensure the accuracy of the floorplan contained here, measurements of doors, windows, rooms and any other items are approximate and no responsibility is taken for any error, omission or mis-statement. This plan is for illustrative purposes only and should be used as such by any prospective purchaser. The services, systems and appliances shown have not been tested and no guarantee as to their operability or efficiency can be given.

Made with Metropix ©2023

Energy Efficiency Rating		Current	Potential
Very energy efficient - lower running costs			
(92 plus) A			
(81-91) B			
(69-80) C			
(55-68) D			
(39-54) E			
(21-38) F			
(1-20) G			
Not energy efficient - higher running costs			
England & Wales	EU Directive 2002/91/EC		

Environmental Impact (CO ₂) Rating		Current	Potential
Very environmentally friendly - lower CO ₂ emissions			
(92 plus) A			
(81-91) B			
(69-80) C			
(55-68) D			
(39-54) E			
(21-38) F			
(1-20) G			
Not environmentally friendly - higher CO ₂ emissions			
England & Wales	EU Directive 2002/91/EC		